

Metal supply diffuser DMP

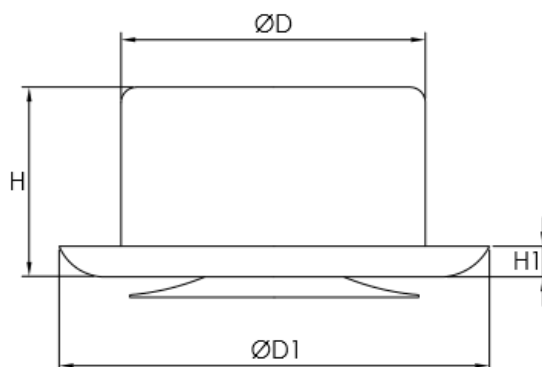

Description

Metal diffuser for supply ventilation

Technical data

| | |
|--------------|---|
| Construction | Made from polymer coated steel Adjustable air flow, with mounting collar |
| Installation | Wall or ceiling mounting with all types of circular ducts |
| Colors | White, anthracite |

Dimensions

| Type | ØD [mm] | ØD1 [mm] | H [mm] | H1 [mm] | m [kg] |
|--------|---------|----------|--------|---------|--------|
| DMP80 | 79 | 116 | 55 | 8 | 0,11 |
| DMP100 | 99 | 140 | 55 | 8 | 0,15 |
| DMP125 | 124 | 167 | 55 | 8 | 0,21 |
| DMP150 | 149 | 200 | 55 | 8 | 0,41 |
| DMP160 | 159 | 210 | 55 | 9 | 0,43 |
| DMP200 | 199 | 247 | 55 | 10 | 0,58 |

Modifications

DMPxxx - white RAL9016 polymer coating
DMPxxxA – anthracite color polymer coating

Technical specifications

